

Congratulations on your choice and purchase of the RUYAN[®] Electronic Cigarette (the “REC Device”). Your use of this product to satisfy your craving and need for nicotine will not produce second hand smoke and will not invade nor contaminate the environment of your loved ones, friends, colleagues, companions or associates. As a result, this product can be used in most public places and where smoking tobacco is otherwise prohibited.

Please read this user’s manual carefully before using the product. This will ensure the most prudent and appropriate use.

Please keep this manual for future reference and information.

NOTE: To avoid the overuse of this product, should you engage it for more than 16 times within any one minute period, the LED indicator at its front will flash continuously for three seconds.

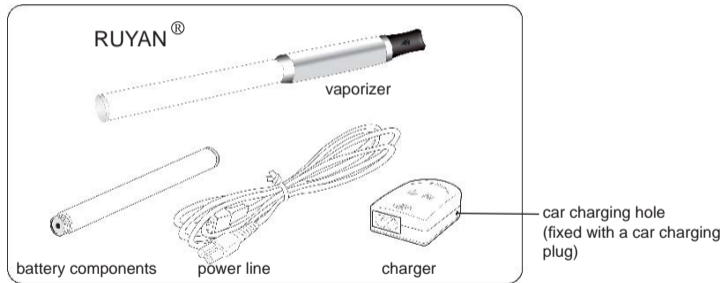

Who Should Use This Product

- Smokers over the age of twenty-one who wish to satisfy their craving and need for nicotine in environments where smoking is prohibited or limited by law, regulation and/or common courtesy.

Who Should Not Use This Product

- Non-smokers.
- Minors under the age of twenty-one.
- Individuals shown to be sensitive to nicotine.
- Pregnant and breast feeding women.

Nicotine and the REC Device

The REC Device's cartridge contains nicotine. Nicotine is a natural alkaloid substance extracted from the tobacco leaf and certain other plants. It is the substance that causes smokers to become addicted. It is addictive! However, nicotine is not a carcinogen. It is not a controlled substance. Since the REC Device does not contain or use tobacco, the device is not determined to be a cigarette, a smoking device or "smokeless" tobacco.

Smoking Equivalency

- The REC Device is used with one REC's nicotine cartridge at a time. Each REC's cartridge contains 16 mg of nicotine, and provides 300 puffs of vapor on average. In contrast, a pack of 20 sticks of common cigarettes contains 22 mg of nicotine (each stick contains 1.1 mg of nicotine), and usually provides 140 to 160 puffs of smoke in total.

- It is recommended that a user inhales no more than 15 times per hour or no more intensely than she or he would otherwise use common cigarettes to satisfy her or his craving or need for nicotine.
- It is recommended that a user inhales no more than 15 times per hour or no more intensely than they would otherwise use common cigarettes to satisfy their craving or need for nicotine.

For the safe and effective use of the REC Device and its supporting products, please read the following very carefully and follow its instructions carefully.

Directions

To prepare the REC Device, insert a new cartridge into the device's vaporizer, correctly

connect the battery to the vaporizer and then suck the mouthpiece to simulate smoking. Replace the cartridge when the density of the vapor produced is significantly reduced. When the LED indicator flashes it is time to replace the device's battery unit with a fully charged unit.

Using the AC Charger

Screw the lithium battery unit into the charger and plug into a standard AC outlet. Avoid using the charger outdoors, exposing it to direct sunlight, or in a damp or humid environment.

Safe Transport or Use

- The REC Device can be safely carried in a pocket or purse provided that it's appropriately protected from other articles and from colliding with these articles.
- The REC Device is a sophisticated electronic product equipped with special supporting

components, i.e. the battery unit, the vaporizer, the cartridge, the charger and the charging cord. None of the components should be forced into the others nor should they be struck or jarred to make work or continue to work.

- The REC Device can be safely used in most public places and does not face the restrictions commonly applied to cigarettes or tobacco products.
- The REC Device does not produce second hand smoke and poses no harm to the surrounding environment or its occupants.
- The REC Device is never lighted and does not pose any fire hazard.
- Do not use the REC Device while driving.
- Keep the REC Device away from high temperatures in its use or storage.

- Keep the REC Device and its components out of the reach of children.
- The most appropriate time and place to use the REC Device is when a user would typically use a traditional cigarette.

The REC Device is a kind of non-flammable electronic cigarette with efficacies similar to those of the common cigarette. It has been demonstrated to refresh and satisfy smokers, without causing second hand smoke and its accompanying dangers.

The REC Device is essentially different from the common cigarette in the following ways:

1. It delivers nicotine without tobacco and without igniting. Nicotine is not currently classified as a carcinogen.
2. It is free of tar and free of the dangers of the 4,000 chemicals commonly produced by a lit, ordinary cigarette, including, but not limited to carbon monoxide.
3. It does not require heat or ignition by flame.
4. It does not produce second hand smoke.
5. It can be used safely in most “no-smoking” areas and poses no fire danger.
6. It uses cartridges of purified, liquid nicotine.
7. It only dispenses the nicotine when actively engaged by the user, thereby significantly limiting the kind of waste that is caused by a lit, neglected, ordinary cigarette.

STRUCTURE OF THE PRODUCT

The body of the REC Device consists of a stainless steel shell, various lithium battery components, microcomputer circuit , a vaporization chamber and a nicotine cartridge.

The nicotine cartridge is composed of a mouthpiece and a container in which specially formulated nicotine is vaporized, free of ingredients such as tar and the 4,000 other substances produced by the common cigarette.



The REC Device employs a 3.7V special lithium battery and special charger. Do not replace this battery or charger with any other type of battery or charger.

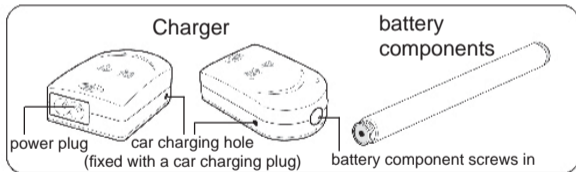

Installation

Screw in the battery components. Open the cartridge, remove the plastic cap of the nicotine container and insert it into the body of the REC Device.

Operating Mode

The REC Device's circuit will be switched on as you inhale and the LED indicator on the device's front end will light simultaneously. Stop inhaling and the vaporization will terminate and the device will return to the standby state. When the device is in the working state, it is recommended that it be placed horizontally and not upwards (vertical), so as to prevent the

inhalation of the liquid into your mouth and cause a stimulus to your oral mucosa. When the LED indicator dims, it's signaling the need to change the battery unit with one that is fully charged.

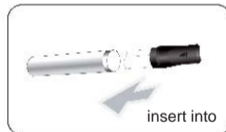
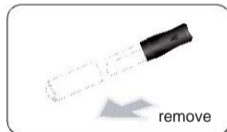
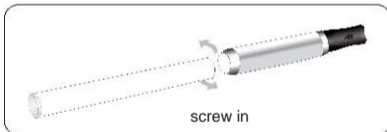

Cleaning

The device is controlled by an internal micro computer which cleans the device after 1500 inhalations. When the device's LED indicator light shines continuously for 8 seconds it shows that the device's computer controlled program is automatically carrying out its cleaning function.

Standby State

The device can and will be in the standby state as soon as the nicotine cartridge is inserted. Once inserted, it is recommended that the cartridge be used within two weeks.

The Battery and Charger

When the device's LED indicator begins to flash, it is time to recharge the battery with the accompanying charger. Screw the battery into the charger. The battery is fully charged in three to four hours, when the charger's indicator light changes from yellow to green.

- Keep the battery away from high temperatures while charging.
- Do not weld the battery or pierce it with a nail or any other tool.
- In the case of an unusual odor, heat generation, discoloration, distortion or abnormality of the battery during the charging process, cut off the power supply, remove the battery from the charger and discontinue its use.

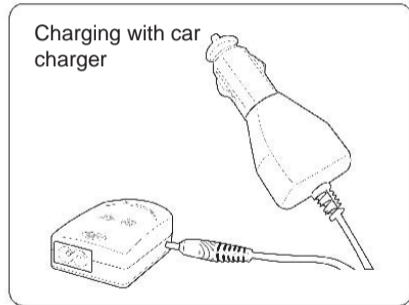
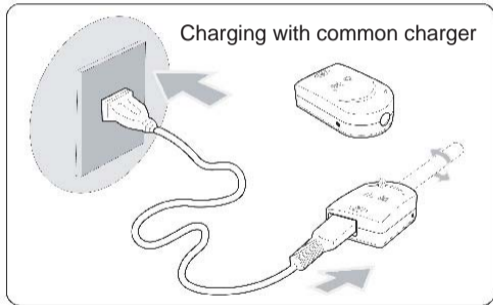

- The charger is designed for the special lithium battery of the REC Device and should not be used with any other battery.
- Keep the battery, the charger and all components of the REC Device out of the reach of children.
- The REC Device is only able to work properly when powered by the battery and charger supplied with the device.
- Initially charge each battery for 8 hours. Thereafter, 3 to 4 hour sessions will be sufficient.

Maintenance and Service

The maintenance and repair of this product must be conducted by RUYAN America. The company takes no responsibility for loss or damage caused by abnormal or careless usage.